

Goppion A-Class

GEOMETRICALLY SIMPLE
DISPLAY CASES, WITH CLEAN
LINES, VISIBLE HINGES AND
LOWERED CASE PLATFORM

A-Class

Geometrically simple display cases, with clean lines, visible hinges and lowered case platform

Av1 type

Vertical display case with door rotating on a pivot hinge on a vertical axis, with glass top.

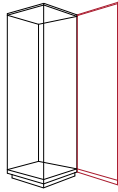

Ah1 type

Horizontal display case with one or two doors rotating on a pivot hinge on a vertical axis.

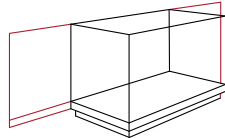
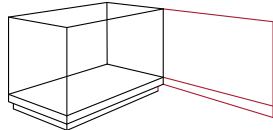

Goppion patented devices that can be fitted

I 2 5 6 8 15 16 17 19



National Museum of African American History and Culture, Washington, D.C. (US).

Av2 type

Vertical display case with sliding door and glass top.

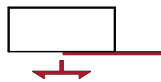
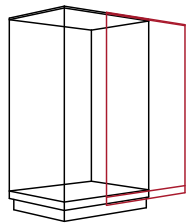

Goppion patented devices that can be fitted

I 2 5 6 15 16 17 19



Rijksmuseum, Main Circuit, Amsterdam (NL).



Rijksmuseum, Main Circuit, Amsterdam (NL).

Av2 type

Av2 cases can be made with low or high base. The glass top has an internal metal frame to lend structural rigidity and accommodate the upper sliding rails.

Dimensions

L = up to 3,000
 P = up to 1,600
 H = up to 2,400
 V = up to 2,300
 B = 100 (low base for passive climate control) min. 400 (high base for active climate control)
 FB = 45
 FT = 21

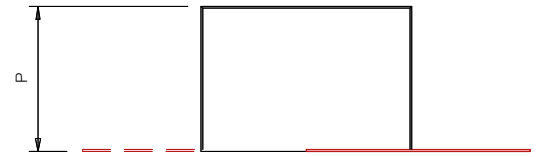
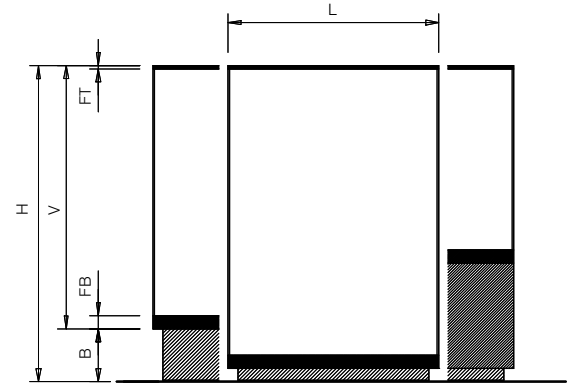
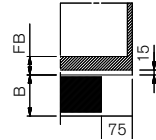
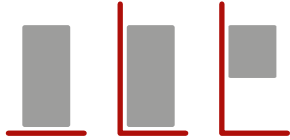

Up to 50% L self-supporting.
 Up to 70% L with door-opening supporting device



Sliding movement

The door slides open or closed without needing to be pulled out or tilted in any way. Steel rails and ball bearings along the bottom take the weight of the door as it slides across, while upper steel rails hold it perfectly vertical.



Rijksmuseum, Main Circuit, Amsterdam (NL).

Multi-door display cases

A-Class display cases can also be made with two, three, or more doors, each up to one meter wide. However, for structural reasons an opening door has to alternate with a fixed section of glass.

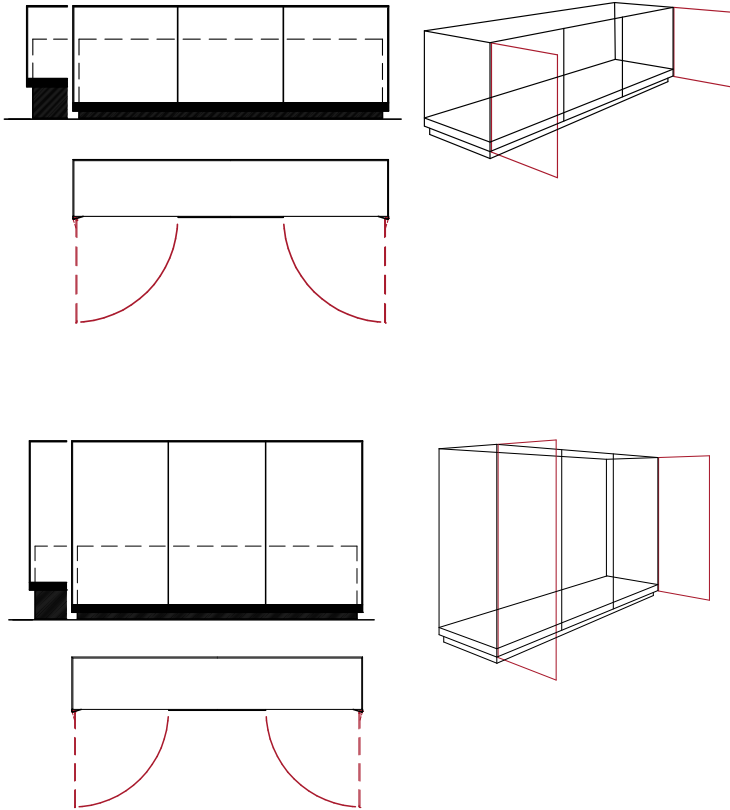

Rijksmuseum, Main Circuit, Amsterdam (NL).