

ALLPLAN ARCHITECTURE **PERFORMANCE HIGHLIGHTS**

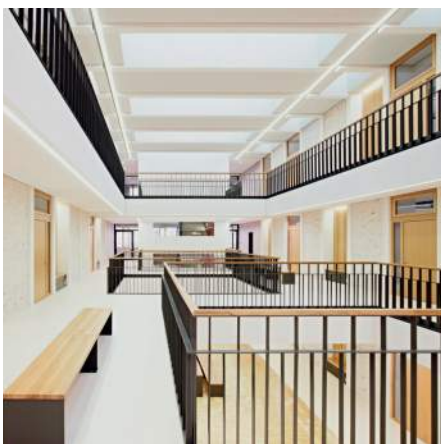

Project: Secondary School Frankfurt Riedberg, Architect: Ackermann+ Raff, Photo: Thomas Herrmann

Allplan Architecture is a universal BIM planning tool with extensive CAD functionality. You can work flexibly either exclusively in the 3D model or in a combination of 2D and 3D, which is a particular advantage in the working drawings. The strength of Allplan Architecture lies in its high reliability and precision across all planning phases, in particular in the area of quantity takeoff. In conjunction with the products Allplan Design2Cost (cost planning), Allplan Engineering (engineering) and Allplan Allfa (facility management), Allplan Architecture offers integrated solutions for civil engineering. By combining Allplan with the cloud-based BIM platform bim+ you profit from a central model storage, visualization and coordination across office and discipline boundaries. A wide range of interfaces – including the internationally certified IFC interface – ensures system-independent data exchange with planning partners.



Project: Secondary School Frankfurt Riedberg, Architect: Ackermann+ Raff, Photo: Thomas Herrmann

PRECISE FREEFORM MODELING

For surface and volume modeling you profit from the world-leading Parasolid 3D modeling kernel from Siemens PLM Software.

EVERYTHING TO DO WITH THE BUILDING FABRIC

Every building type can be modeled precise and in detail – ranging from the foundation through to the roof. For the finish you find functions like the window and door modeler, room finish specifications, a variety of facades etc.

HIGH QUALITY VISUALIZATIONS

With Allplan Architecture you create realistic visualizations from the 3D model for customer presentations or competitions. For this Allplan provides the Real Time Renderer as well as the integrated CineRender by MAXON.

ACCURATE LAYOUTS AND QUANTITIES

With Allplan Architecture the quality of your designs rises and your workflows become more efficient. You derive views, sections and visualizations from the model quick and easy. You also create comprehensive evaluations out of your building model: You get standard-conform quantity takeoffs and graphically appealing reports.

AN OVERVIEW OF ALLPLAN ARCHITECTURE

Intelligent building model	An intelligent building model opens up new possibilities to you. You can not only derive floor plans, cross sections, views or details for different planning phases, but also create visualizations, complex area and quantity analyses for building permits, cost determinations and tenders, and deliver the building data to planning partners such as structural engineers for further use. Working in a building model is particularly advantageous when it comes to changes and adjustments to the original planning. All changes are carried out centrally only once and transferred to all plans in the process. This lowers the risk of error und helps to save time. The building model can also be enriched by parametric Allplan CAD objects, so-called SmartParts. They include numerous, intelligent manufactures data – from escalators up to interieur.
Flexible building structure	Organize your building structure data analogous to the topology of the building and generate cross-sections, views and analysis lists quickly and conveniently directly from the building structure. Through efficient reference planes and the visual plane manager, adjustments to the height of of individual floors can be made quickly.
Comprehensive assessment of rooms and areas	Whether you work in 2D or use a building model: Take advantage of the convenient room creation and labeling as well as the range of analyses of living spaces, base area and capacity according to Floor Space Regulations (WoFIV) and/or DIN 277. With the help of new reports create appealing analyses including illustrative graphics. You can optionally define wall, ceiling and floor coverings for every room and use the legend generator for the analysis and visualization of flooring, room size, etc.
Comprehensible quantity takeoff	You can establish the quantities of all Allplan components comprehensively and quickly and use them for cost determination and TAI. The quantity takeoff is comprehensible, includes cost estimation and illustrative graphics and takes place in accordance with German standards (e.g., German Construction Contract Procedures (VOB). The areas and quantities determined can be printed in the form of graphically appealing reports, saved as PDF or Excel files or forwarded directly for cost determination and tender to suitable software such as Allplan BCM. The integrated cost planning is enabled through corresponding CAD planning data.
Convincing presentations	With the Real Time Renderer, you can create a realistic, interactive animation of the building model in just a few seconds. You therefore have immediate visual feedback and can check various views, camera settings and materials. In this way, you can select the best possible scene setup. In the render materials, you set uneven surfaces (bump maps), reflections or luminous objects and therefore achieve a high level of detail. Exterior renderings look even more realistic, thanks to the new physical sky. With the support of high dynamic range images (HDR), even large differences in brightness can be reproduced in detail. You can create high-resolution renderings with the help of the extremely powerful CINEMA 4D Render Engine CineRender, integrated in Allplan. If you want to edit your presentation further and give it a really professional finishing touch, the optimized export to CINEMA 4D is the perfect solution for you. You can now copy render materials, illumination and camera settings directly from Allplan.
Practical wood and facade construction	You can easily create wood and steel components and place complete rafter systems in existing roof spaces. The construction of the building envelope (facade) takes place according to the principle of a modular building system - simply, flexibly and quickly: In a grid with partitions, freely scalable, pre-defined or individual facade objects fit in automatically. The facade can be changed quickly and intuitively via handles. All components can be analyzed via different reports according to type, material and price.
Professional layout and design	Quickly combine drawings, pictures and text for outstanding plans, construction presentations and reports. Functions for alignment and distribution support your professional layout. Use fill areas with color gradient and transparency, textures in 2D and 3D, as well as the depth offset of elements, to provide your plans with realistic effects and a professional design.
More efficient data exchange per PDF	Plans in the PDF format facilitate efficient communication – even 3D models can be integrated from the animation windows into PDFs and viewed in the Adobe Reader by each user. For archiving purposes, the “PDF-A” format can be created; its ISO standardization guarantees legibility for many years. Import of PDF documents is also supported: You can then import survey plans or manufacturer data by Drag&Drop.
Unlimited interoperability	DXF, DWG, DGN or IFC: Allplan offers multiple exchange possibilities. The interface technology with Favorites provides high-quality data exchange. Facility management software can be integrated and the exchange with CINEMA 4D, Google Earth, Lumion and many other programs operates smoothly.

**CURRENT SYSTEM REQUIREMENTS ARE AVAILABLE AT
WWW.ALLPLAN.COM/INFO/SYSINFO**

For unlimited use of Allplan a graphics card with a minimum of 1 GB RAM needs to be available as well as a Windows 64Bit system.

**MAKE MORE OUT OF ALLPLAN –
WITH THE PLUS IN SERVICE!**

Allplan Architecture is also available with a Serviceplus contract. With Serviceplus your software is always up to date. Strengthen your competitive position, increase your leading edge.

More information at www.allplan.com/serviceplus